

# South Harbour • Seawalk

South Harbour • Seawalk

## Information Sheet



### What are the benefits to the community?

#### **SOUTH HARBOUR:**

The South Harbour is a working harbour owned by Small Craft Harbours and operated by the City of Powell River, primarily to provide moorage and shelter for commercial fishing vessels and transient recreational boaters.

A report by the Powell River Regional Economic Development Society (PRREDS) found that many boats bypass Powell River because the aging structures are too small and narrow to accommodate them. The City of Powell River, PRREDS and Community Futures Powell River propose to increase moorage space from approximately 800 meters (2625 feet) to approximately 1270 meters (4155 feet) enabling the South Harbour to accommodate and attract the growing market need for the wider range of boat size.

It is important to note that the South Harbour expansion is intrinsically linked to the revitalization of the Wharf at Westview since the harbour is accessed via gangway from the wharf.

The South Harbour expansion portion of the waterfront development project will attract significantly greater numbers of commercial and transient recreational vessels to the area by:

- Doubling the current wharf space and increasing float sizes to accommodate larger vessels
- Realigning the breakwater to improve access to the harbour
- Removing the industrial operations currently on the foreshore
- Rebuilding the service industry required to support increased visitors to an active waterfront community
- Developing the framework for commercial marine services along the waterfront

#### **SEAWALK:**

A Seawalk of 1.3 km was constructed to stabilize the bank along Highway 101 and create a pedestrian corridor along the waterfront, beginning at the barge terminal and running south to the bottom of Oliver Street. With the expansion of the South Harbour, the intention is to extend the Seawalk from the former barge terminal to the Wharf at Westview to create a continuous, accessible waterfront walkway.

### How much will the project cost and how is it being funded?

#### **SOUTH HARBOUR:**

The total cost is budgeted at \$6.04 million

- \$2 million from the Community Adjustment Fund as announced on Nov. 7, 2009. This is a federal government program administered by Western Economic Diversification Canada as part of the government's stimulus plan to mitigate the impacts of the economic downturn.
- \$2.3 million grant from the Island Coastal Economic Trust (ICET).
- \$1.9 borrowing

#### **SEAWALK:**

- \$40,000 for the initial Seawalk construction project along Highway 101. This was a partnership between Ministry of Transportation, the City of Powell River and Sliammon First Nation.
- Funding for the north entrance realignment has yet to be identified.



Continued on back...

# South Harbour • Sea Walk Information, Continued

## What are the environmental impacts?

As a result of disturbing some localized marine habitat in the construction of the current Seawalk, the city was required by Fisheries & Oceans Canada to provide compensation by way of creating alternative habitat. For this reason, a saltwater marsh was created in the South Harbour. Work continues on this marsh to ensure that habitat is functioning as intended and to replace the plants in the marsh area that did not flourish at an adequate rate.

## How will this project affect my taxes?

Borrowing for the South Harbour project in the amount of approximately \$1.9 million will be repaid over 25 years at an interest rate of 1.4%, making the annual debt service cost approximately \$124,000. The debt service payments will be met through taxation.

Seawalk environmental compensation plan map

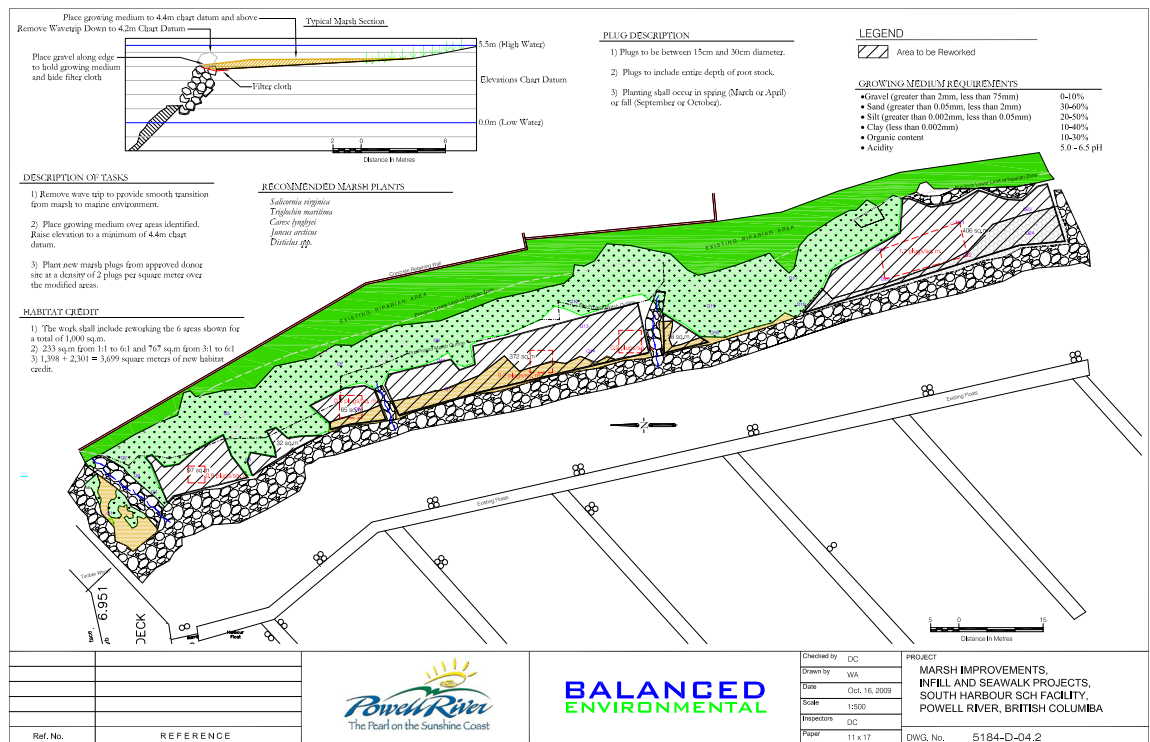

## What are the timelines and next steps?

### SOUTH HARBOUR:

- In 2005, the first stage float planning to reconfigure the South Harbour was completed by Stantec Consulting Ltd. This stage was funded by Community Futures Powell River and assisted by PRREDS.
- Construction planning for the expansion has just been handed over to Engineering Services.
- All work must be completed by March 2011 in accordance with the terms of the Community Adjustment Fund.

### SEAWALK:

- Further phases of the Seawalk are in conceptual design stage with the Waterfront Committee. Preliminary plans will connect the walkway to the Wharf at Westview development, and will also include parking, landscaping and signage.
- The City will work with Sliammon First Nation on the wording for interpretive signage along the Seawalk for the midden and any other First Nations artifacts to be featured.
- Target completion date is Spring 2010.